

FMT-02

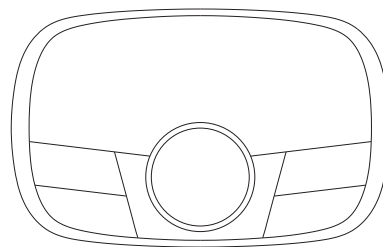

GB

Version 1



The Bluetooth® word mark and logos are registered trademarks owned by Bluetooth SIG, Inc. and any use of such marks by SANGEAN ELECTRONICS INC. is under license.

Important safety instructions

- 1.** Follow the operating instructions provided and take note of any warnings.
- 2.** If you do not follow the operating instructions provided, it may compromise the safety of your product and this may invalidate the warranty.
- 3.** Only use the supplied 5V cigarette type car power adaptor with your product.
- 4.** Do not install your product in a way that may interfere with the safe operation of the vehicle, or affect the deployment of air bags or other safety items. Do not install cables and wires near the steering wheel.
- 5.** Do not place your product on or near sources of your vehicle's heat or ventilation.
- 6.** Do not use your product in a way that may cause careless driving or improper control of your vehicle.
- 7.** Keep your product dry and only clean with a dry cloth.
- 8.** Do not expose your product to naked flames.
- 9.** Do not use your product in extremely hot or cold temperature.
- 10.** If you need to connect your product to the rear of your vehicle's head unit, remove any power before you start to install your product. When you have safely installed your product, you can reconnect the power. See your vehicle's owner's manual for more information.
- 11.** Do not use the product if it is damaged.
- 12.** Product repairs should only be carried out by authorized personnel.
- 13.** For your driving safety, do not operate your product while driving.
- 14.** SANGEAN is not reliable for any damage caused by usage of the product while driving.

GB

F

E

NL

D

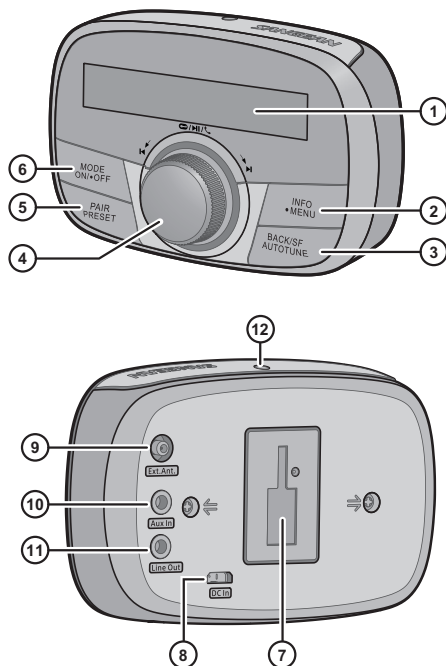

Controls and connections

①	LCD display
②	Info / Menu button
③	Back / Auto tune / SF(Service following) button
④	Tuning control / Next / Previous knob / Select / Play / Pause / Call button
⑤	Bluetooth pairing / Preset button
⑥	Mode / Power On / Off button

⑦	Sliding slot
⑧	Micro USB socket
⑨	External antenna socket
⑩	Auxiliary input socket
⑪	Line out socket
⑫	Microphone

Supplied accessories

Car mount (Suction cup holder)

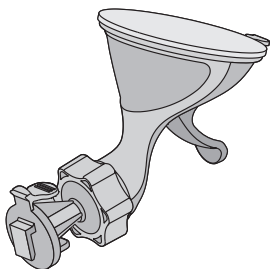

5V cigarette type car power adaptor

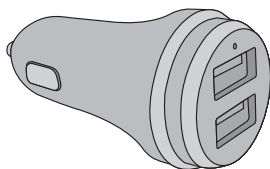

USB cable

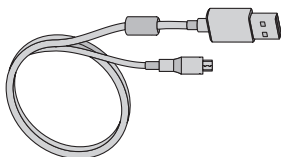

External DAB / DAB+ antenna

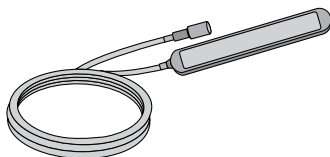

GB

F

E

NL

D

Getting started

Installing your GoTune

Before you can start using your GoTune, you need to do the following:

1. Position the antenna in your vehicle.
2. Connect the antenna to GoTune.
3. Install the Car mount and GoTune.
4. Power your GoTune.
5. Connect the GoTune to your vehicle's audio system with an auxiliary cable or by FM radio.

Vehicle requirements

1. Fitted audio system with auxiliary (3.5mm) port or FM receiver.
2. Standard 12V negative earth power supply. GoTune is not suitable for use with a 24V power supply.

Getting the best DAB signal

As with FM radio, DAB signal coverage changes depending on your location. As you use the GoTune in your vehicle, you may travel through areas where DAB signal coverage is poor. To help get the best DAB signal when coverage is poor or there is a weak signal:

- Follow the installation instructions carefully.
- Ensure the antenna is attached to GoTune.
- Use the supplied 5V cigarette type car power adaptor, as other third-party adapters can cause interference.
- Switch off other devices in your vehicle that aren't in use. Devices such as satellite navigation systems and dashboard cameras can cause interference.

Where to install your GoTune

⚠ It's important to install your GoTune in a safe location in your vehicle. Do not fit any components in locations that may interfere with safe operation of the vehicle, or affect the deployment of air bags or other safety products. Keep cables and wires away from the steering wheel.

GB

Consider carefully where to install the GoTune in your car.

The GoTune should not block or interfere with any of the following:

F

- Your view of the road
- Any of the controls in your car
- Any of your mirrors
- The airbag

E

NL

D

When the GoTune is installed in your car, you should be able to reach the device easily without leaning or stretching. The diagram shows where you can safely install the car mount and GoTune.

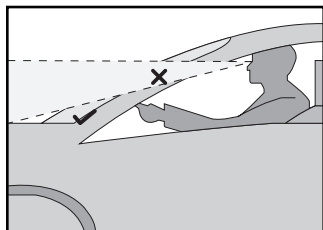

Where to install the DAB antenna

We recommend you install the DAB antenna for your GoTune in the top corner of the windscreen, on the passenger's side of your vehicle.

Install the DAB antenna so that it is not within the swept area of the windscreen. Make sure the DAB antenna and GoTune do not obstruct the view of the driver.

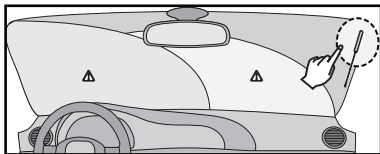

⚠ NOTE

If you have a heated windscreen in your vehicle, or the windscreen contains metallic UV filters, it can cause interference for the DAB signal. Install the DAB antenna on a part of the windscreen that does not contain heating elements or UV filters.

For more information on where to safely and legally install your GoTune in your vehicle, contact your local transport office if needed.

Positioning and Connecting the DAB antenna

- 1 Choose a position for the DAB antenna, so that it's as high as possible on the windscreen and at least 4cm from the side of the windscreen.

⚠ NOTE

Make sure the DAB antenna does not obstruct the view of the driver.

- 2 Clean the chosen area of the windscreen with a cleaning cloth and wait for it to dry.

- 3 Unpeel the backing from the antenna and stick the antenna onto your windscreen.

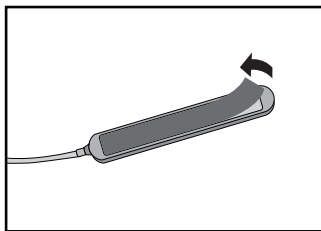

- 4 Place the antenna cable so that it follows a path to GoTune. If possible, tuck the cable behind the trim down the side of your windscreen. Alternatively, secure the cable to your windscreen and dashboard with selfadhesive clips.

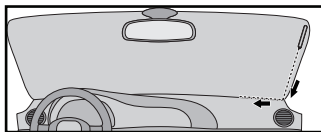

GB

F

E

NL

D

- 5** Insert the antenna cable into the external antenna socket of GoTune.

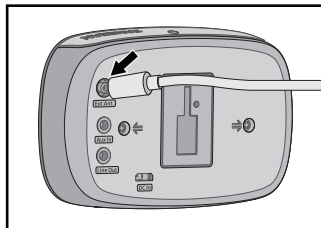

Installing the car mount and GoTune

- 1** Choose an area on your vehicle's windscreen where you want to install the car mount and GoTune. Clean the surface with a cleaning cloth and wait for it to dry.

NOTE

Make sure the car mount and GoTune does not obstruct the view of the driver.

- 2** Pull open the lever on the car mount first. Press the suction cup firmly against the windscreen on the chosen area, and then push back the lever to lock the suction cup that allows it to hold securely to the windscreen.

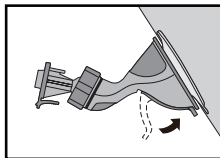
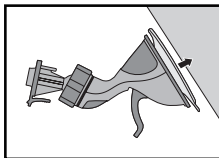
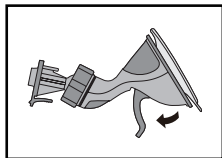

- 3** Insert the car mount to the slot on the rear of the GoTune, and then slide GoTune until you hear it click into position.

Rotate the nut in a anti-clockwise direction to loosen the swivel, so that the ball head allows 360 degree rotation and easy adjustment for optimal viewing and then rotate the nut in a clockwise direction to fasten the GoTune.

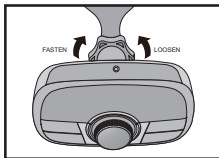
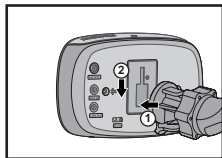

Using your GoTune for the first time

- 1 Insert the USB power cable into the micro USB socket on the rear of GoTune and insert the other end to the supplied 5V cigarette type car power adaptor, then insert the power adaptor into your vehicle's power socket. The display will show "Welcome to Digital Radio" for a few seconds. Your GoTune will perform a scan of the Band III DAB channels and will normally update the clock automatically using the DAB signal. If no signals are found, it may be necessary to relocate the antenna to a position giving better reception. After a power failure the GoTune will then set its clock the next time that you turn on the unit in DAB mode.

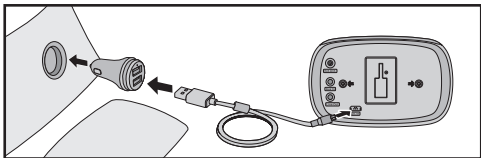

- 2 Choose how to connect your GoTune to your vehicle's audio system.
 - If connecting your GoTune with an auxiliary cable, choose Line out .
 - If connecting your GoTune by FM radio, choose 'FM TX'(FM transmitter)mode and then choose an FM frequency. Ensure a radio station isn't using the frequency you choose. Tune your vehicle's audio system to the same FM frequency your GoTune. To easily find the FM frequency in the future, save it as a preset on your vehicle's audio system.

Line out socket

A 3.5mm Line out socket located on the rear of your GoTune is provided for connecting the audio signal to an external amplifier. Insert an audio cable into this socket and insert the other end into the vehicle's auxiliary socket.

Adjust the Volume control on the vehicle's audio system to the required level.

NOTE

When selecting Line out to connect your GoTune to your vehicle's audio system, there may be interference noises due to different vehicles.

FM transmitter (FM TX mode)

1. Press the Power On / Off button to switch on your GoTune.
2. Press the Mode button to select FM TX mode.
3. Press the Autotune button to scan the FM frequency. The frequency of 10 unused radio stations will be automatically stored in the preset list.

GB

F

E

NL

D

4. Press and release the Preset button to display the 'Preset Recall' menu. Rotate the Tuning Control knob to select the desired preset frequency. Press and release the Tuning Control knob.
5. Tune your vehicle's audio system to the same FM frequency your GoTune. Your vehicle's audio system will connect to GoTune. Press the Mode button to select your desired play mode (DAB / Bluetooth / Auxiliary Input).
6. Adjust the Volume control on the vehicle's audio system to the required level.
7. To switch off your GoTune, press and hold the Power On / Off button.

Manual tuning – FM transmitter

1. Press the Power On / Off button to switch on your GoTune.
2. Press the Mode button to select FM TX mode.
3. Rotate the Tuning control knob to tune to a frequency. The frequency will change in steps of 100kHz. Ensure a radio station isn't using the frequency you choose.
4. Tune your vehicle's audio system to the same FM frequency your GoTune. Your vehicle's audio system will connect to GoTune. Press the Mode button to select your desired play mode (DAB / Bluetooth / Auxiliary Input).
5. Adjust the Volume control on the vehicle's audio system to the required level.

Disabling / Enabling FM transmitter

1. Press the Power On / Off button to switch on your GoTune.
2. Press and hold the Info / Menu button to access the menu for the current mode.
3. Rotate the Tuning control knob to select "Fm Tx Disable" and press the Tuning control knob to enter the setting.
4. Rotate the Tuning control knob to select "Fm Tx On" or "Fm Tx Off". To activate the FM transmitter function, select "Fm Tx On" and press the Tuning control knob to confirm the setting. To disable the FM transmitter function, select "Fm Tx Off" and press the Tuning control knob to confirm the setting.

NOTE

When there is not any audio signal input into GoTune, the transmission will be turned off within 30 seconds. When the audio signal is input again, the transmission will be restarted within 3 seconds.

Operating your GoTune – DAB

1. Press the Power On / Off button to switch on your GoTune.
2. Choose the way that you have connected GoTune to your vehicle's audio system as previously described.
3. Press the Mode button to select DAB mode.

4. If this is the first time the GoTune is used, a quick scan of Band III DAB channels will be carried out. If the GoTune has been used before, the last used station will be selected.
5. During Autotune, as new stations are detected, the station counter on the right hand side of the display will increase and stations will be added to the list. The display shows a bar graph indicating progress of autotune.
6. When the Autotune is completed, the first station (in numeric-alpha order 0...9...A...Z) will be selected.
7. If the station list is still empty after the Autotune, your GoTune will display "No Station Found".
8. If no signals are found, it may be necessary to relocate the antenna to a position giving better reception.

Selecting a station – DAB

1. Press the Power On / Off button to switch on your GoTune.
2. Press and release the Mode button until the DAB mode is selected. The display will show the name of the radio station currently selected.
3. Rotate the Tuning control knob to scroll through the list of available stations.
4. Press and release the Tuning control knob to select the station. The display may show "Connecting..." while your GoTune finds the new station.
5. Adjust the Volume control on the vehicle's audio system to the required level.

NOTE

If after selecting a station, the station is not found it may be necessary to relocate the antenna to a position giving better reception.

Secondary service – DAB

1. Certain radio stations have one or more secondary services associated with them. If a station has a secondary service associated with it, the display will show ">>" next to the station name on the station list. The secondary service will then appear immediately after the primary service as you rotate the Tuning control knob.
2. Press and release the Tuning control knob to select the station. Most secondary services do not broadcast continually and if the selected service is not available, the radio will re-tune to the associated primary service.

Display mode – DAB

Your GoTune has a range of display options when in DAB mode:

1. Press and release the Info / Menu button to cycle through the various modes.

GB

F

E

NL

D

a. Scrolling text (DLS)	displays scrolling text messages such as artist / track name, phone in number, etc.
b. Signal strength	displays the signal strength of radio reception. The clear unfilled rectangle indicates minimum signal level required for satisfactory reception.
c. Program type	displays type of station being listened to e.g. Pop, Classic, News etc.
d. Multiplex name	displays name of multiplex to which current station belongs.
e. Channel & frequency	displays current channel and frequency.
f. Bit rate / audio type	displays the digital bit rate and the audio type for the currently tuned DAB station.
g. Time	displays the current time.
h. Date	displays the current date.

Finding new stations – DAB

As time passes new stations may become available. To find new stations proceed as follows:

1. When in DAB mode, to carry out a full scan of the entire DAB Band III frequencies, press and hold the Autotune button.
2. As new stations are found, the station counter on the right hand side of the display will increase and stations will be added to the list.

Manual Tuning – DAB

Manual tuning allows you to tune directly to the various DAB band III channels.

1. When in DAB mode press and hold the Info / Menu button to enter the DAB menu list.
2. Rotate the Tuning control knob to select "Manual Tune". Press and release the Tuning control knob to enter manual tune mode.
3. Rotate the Tuning control knob to select the required DAB channel. Press and release the Tuning control knob to cause the GoTune to tune to the chosen channel.
4. Press the Back button to return to manual tune mode and then choose a different DAB channel.

Dynamic Range Control (DRC) setting – DAB

DRC can make quieter sound easier to hear when your GoTune is used in a noisy environment.

1. When in DAB mode press and hold the Info / Menu button to enter the DAB menu list.
2. Rotate the Tuning control knob to find "DRC". Press and release the Tuning control knob to enter the adjustment mode.

3. Rotate the Tuning control knob to select required DRC setting (default is off).
 - Off DRC is switched off. Broadcast DRC will be ignored.
 - High DRC is set as sent by broadcaster.
 - Low DRC level is set to 1/2 that sent by broadcaster.
4. Press and release the Tuning control knob to confirm the setting.

NOTE

Not all DAB broadcasts are able to use the DRC function. If the broadcast does not support DRC, then the DRC setting in the radio will have no effect.

Prune stations

If you move to a different part of the country, some of the stations which were listed may no longer be available.

Also from time to time, some DAB services may stop broadcasting, or may change location or frequency.

Stations which cannot be found, or which have not been received for a very long time are shown in the station list with a question mark. The prune stations function will delete the marked DAB stations from your station list.

1. When in DAB mode press and hold the Info / Menu button to enter the DAB menu list.
2. Rotate the Tuning control knob to find "Prune Station". Press and release the Tuning control knob to enter the adjustment mode. Then rotate the Tuning control knob to select "Yes" or "No". To activate the Prune function select "Yes", and press and release the Tuning control knob to confirm the setting.
3. If you do not wish to prune stations, select "No" and then press and release the Tuning control knob to confirm the setting.

NOTE

If you have moved your GoTune to a different part of the country you should also carry out a search for new stations (please see the section 'Finding new stations').

GB

F

E

NL

D

Traffic announcement On / Off setting

Whenever a traffic announcement (TA) is broadcast, the Gotune can be set to switch automatically from a station that does not provide traffic reports to the appropriate traffic information station within the broadcasting network that does.

Once the traffic report has been played, the Gotune will switch back to the programme that you were listening to before.

1. When in DAB mode press and hold the Info / Menu button to enter the DAB menu list.
2. Rotate the Tuning control knob to find "Announcement". Press the Tuning control knob to enter the setting.

3. Rotate the Tuning control knob to select "On" or "Off". To activate the traffic announcement function, select "On". Press the Tuning control knob to confirm the setting. To disable this function, select "Off". Press the Tuning control knob to confirm the setting.

DAB service following function

If the reception quality of the programme being received decreases, the GoTune can automatically tune to the programme in another ensemble (if available). For this feature to work, the service following function must be activated.

Press the SF button to switch service following on / off. The "S/F" symbol on the display shows that the service following function is activated.

Alternative you can set it in the DAB menu.

1. When in DAB mode press and hold the Info / Menu button to enter the DAB menu list.
2. Rotate the Tuning control knob to find "Service Following". Press the Tuning control knob to enter the setting.
3. Rotate the Tuning control knob to select "On" or "Off". To activate service following, select "On". Press the Tuning control knob to confirm the setting. The "S/F" will appear on the display. To disable this function, select "Off". Press the Tuning control knob to confirm the setting. The "S/F" will disappear on the display.

GB

F

E

NL

D

Presets in DAB and FM Tx modes

There are 10 memory presets each for DAB radio and FM transmitter. They are used in the same way for each operating mode.

1. Press the Power On / Off button to switch on your GoTune.
2. Tune to the required radio station / frequency as previously described.
3. Press and hold the Preset button to enter the "Preset Store" menu. Rotate the Tuning Control knob to scroll through the preset list until you reach an unused preset or a preset that you wish to change. Press and release the Tuning Control knob to store the preset. "Preset 1 Stored" (for example) will be shown on the display. The corresponding preset number e.g. "P1" will show on the display. Repeat this procedure for the remaining presets.
4. Stations which are already stored in the presets may be over written by following the above procedure.

Recall a preset in DAB and FM Tx modes

1. Press the Power On / Off button to switch on your GoTune.
2. Press the Mode button to select the required operating mode.
3. Press and release the Preset button to display the 'Preset Recall' menu. Rotate the Tuning Control knob to select the desired preset station / frequency. Press and release the Tuning Control knob. Your GoTune will then tune to the station / frequency stored in the selected preset memory.

Listening to music via Bluetooth streaming

You need to pair your Bluetooth device with your GoTune before you can auto-link to play / stream Bluetooth music through your GoTune. Pairing creates a 'bond' so two devices can recognize each other.

Pairing and playing your Bluetooth device for the first time

1. Press the Power On / Off button to switch on your GoTune. Choose the way that you have connected GoTune to your vehicle's audio system as previously described. Press the Mode button to select Bluetooth mode. "Pairing" will show and flash on the display of the GoTune.
2. Activate Bluetooth on your device according to the device's user manual to link to the GoTune. Locate the Bluetooth device list and select the device named 'FMT-02' (With some Smartphone's that are equipped with earlier versions than BT2.1 Bluetooth device, you may need to input the pass code "0000").
3. Once connected, the name of your connected Bluetooth device will be shown on the display. You can simply select and play any music from your source device. The volume control can be adjusted from your source device, or directly from the vehicle's audio system.
4. Use the controls on your Bluetooth-enabled device or on the GoTune to play / pause and navigate tracks.

NOTE

1. If 2 Bluetooth devices are pairing for the first time, both must search for your GoTune, it will show its availability on both devices. However, if one device links with this unit first, then the other Bluetooth device will not be found on the list.
2. If you take your source device out of range, the connection will be temporarily disconnected to your GoTune. Your GoTune will automatically reconnect if the source device is brought back in range. Be aware that during the period of disconnection, no other Bluetooth device can pair or link with your radio.
3. If 'FMT-02' shows in your Bluetooth device list but your device cannot connect with it, please delete the item from your list and pair the device with the GoTune again following the steps described previously.
4. The effective operation range between the system and the paired device is approximately 10 meters (30 feet). Any obstacle between the system and the device can reduce the operational range.
5. Bluetooth connectivity performance may vary depending on the connected Bluetooth devices. Please refer to the Bluetooth capabilities of your device before connecting to your GoTune. All features may not be supported on some paired Bluetooth devices.
6. With some mobile phones, making / receiving calls, text messages, e-mails or any other activities unrelated to audio streaming may mute the Bluetooth audio streaming or even temporarily disconnect from your device. Such behavior is a function of the connected device and does not indicate a fault with your GoTune.

GB

F

E

NL

D

Playing audio files in Bluetooth mode

When you have successfully connected your GoTune with the chosen Bluetooth device you can start to play your music using the controls on your connected Bluetooth device.

1. Once playing has started adjust the volume to the required setting using the volume control on your vehicle's audio system or on your enabled Bluetooth device.

NOTE

When in Bluetooth mode, if the input signal is too large, the output sound of vehicles audio system may be unstable. It is recommended to turn down the volume of your Bluetooth device.

2. Use the controls on your Bluetooth source device to play / pause and navigate tracks.
3. Alternatively, control the playback using Tuning control knob on the GoTune.
To Pause or Play the current track, press the Tuning control knob.
To play the next track, rotate the Tuning control knob in a clockwise direction.
To play the previous track, rotate the Tuning control knob in a anti-clockwise direction.

NOTE

Not all player applications or devices may respond to all of these controls.

GB

F

E

NL

D

4. If your connected device is able to provide information from the track being played, you may press and release the Info / Menu button to display the Track status, Track name, Artist, Album, Time and Date details on the display. Note that the availability of information depends on the specific media format.

Playing a previously-paired Bluetooth source device

The GoTune can memorize up to 8 paired Bluetooth source devices, when the memory exceeds this amount, the earliest pairing device will be over written from the device. If your Bluetooth source device already paired with the GoTune previously, the unit will memorize your Bluetooth Source device and will attempt to reconnect with a Bluetooth source device in the memory that was last connected. If the last connected Bluetooth source device is not available, the GoTune will try to connect to the second last Bluetooth source device.

Disconnecting your Bluetooth device

Press and hold the Bluetooth pairing button to disconnect with your Bluetooth device.

You can also press the Mode button to select any mode other than Bluetooth mode or turn off Bluetooth on your Bluetooth source device to disable the connection.

If you disconnect the Bluetooth device when you are in Bluetooth mode, the "Pairing" will show and flash on the display, indicating Bluetooth is available again for pairing.

Using your hands-free call feature

Your unit can be used as a hands-free accessory for your phone. When music is playing through your GoTune and vehicle's audio system, if you receive a call on your phone it can pause the music automatically to allow you to answer your phone.

1. When there is an incoming call, press the Call button on the GoTune to answer your phone call.
2. Speak in direction of the built-in microphone. Note that a very high volume setting may decrease sound quality.
3. Press the Call button to end the phone call.

Auxiliary input socket

A 3.5mm stereo Auxiliary Input socket is provided on the rear of your GoTune to permit an audio signal to be fed into the unit from an external audio device such as iPod, MP3 or CD player.

1. Press the Power On / Off button to switch on your GoTune.
2. Choose the way that you have connected GoTune to your vehicle's audio system as previously described.
3. Press the Mode button to select Auxiliary Input mode.
4. Connect an external audio source (for example, iPod, MP3 or CD player) to the Auxiliary Input socket.
5. Adjust the volume setting on your iPod, MP3 or CD player to ensure an adequate signal level from the player, and then use the volume control on the vehicle's audio system as needed for comfortable listening.

NOTE

When in Auxiliary Input mode, if the input signal is too large, the output sound of vehicles audio system may be unstable. It is recommended to turn down the volume of your external audio device.

GB

F

E

NL

D

Sleep timer

Your radio can be set to turn off after a preset time has elapsed. The sleep timer setting can be adjusted between 15 and 180 minutes.

1. Press the Power On / Off button to switch on your GoTune.
2. Press and hold the Info / Menu button to access the menu for the current mode.
3. Rotate the Tuning control knob to select "System" and press the Tuning control knob to enter the system settings menu.
4. Rotate the Tuning control knob to select "Sleep" and press the Tuning control knob to enter the setting.
5. Rotate the Tuning control knob to select the desired sleep time (15,30,60,90,120,180). Select the "Sleep Off" to cancel the sleep function.
6. Press the Tuning control knob to confirm the setting. An active sleep timer is shown using a symbol "S" on the playing display. Your radio will switch into power off mode after the preset time has elapsed.
7. To view the remaining time of an active sleep timer setting, go back to steps 2-4. The remaining time will show on the display.

8. To cancel the sleep timer before the preset time has elapsed and to turn off the radio, press the Power button to turn the unit off manually.

Language selection

By default your GoTune will display all menus and messages in English. You can choose your preferred language.

1. Press the Power On / Off button to switch on your GoTune.
2. Press and hold the Info / Menu button to access the menu for the current mode.
3. Rotate the Tuning control knob to select "System" and press the Tuning control knob to enter the system settings menu.
4. Rotate the Tuning control knob to select "Language" and press the Tuning control knob to enter the language adjustment menu.
5. Rotate the Tuning control knob until your desired language appears on the display. Press the Tuning control knob to confirm your choice. The display will change to the chosen language. The chosen language will be marked with an asterisk.

GB

Dimmer

The brightness of the display can be adjusted when the GoTune is in use.

1. Press the Power On / Off button to switch on your GoTune.
2. Press and hold the Info / Menu button to access the menu for the current mode.
3. Rotate the Tuning control knob to select "System" and press the Tuning control knob to enter the system settings menu.
4. Rotate the Tuning control knob to select "Dimmer" and press the Tuning control knob to enter the setting.
5. Rotate the Tuning control knob to adjust your required brightness level and press the Tuning control knob to save the setting.

Factory reset

If your GoTune fails to operate or some digits on the display are missing or incomplete, carry out the following procedure.

1. Press the Power On / Off button to switch on your GoTune.
2. Press and hold the Info / Menu button to access the menu for the current mode.
3. Rotate the Tuning control knob to select "System" and press the Tuning control knob to enter the system settings menu.
4. Rotate the Tuning control knob to select "Factory Reset" and press the Tuning control knob to enter the setting.

5. Rotate the Tuning control knob to select “Yes” or “No”. If you do not wish to carry out a system reset, select “No” and then press the Tuning control knob to confirm the setting.
6. With “Yes” selected, press the Tuning control knob. A full reset will be performed. All presets and station lists will be erased. All settings will be set to their default values. After a system reset, the GoTune will be restarted. The display will show “Welcome to Digital Radio” and a scan of the DAB band III will be performed. In case of malfunction due to electrostatic discharge, reset the product (reconnection of power source may be required) to resume normal operation.

Software upgrade

From time to time, new software features for your GoTune may be developed. Your GoTune has therefore been designed to allow its internal software to be updated using your USB upgrade port.

You should not attempt to update your GoTune unless it is recommended to you by Sangean Customer Services.

Updating the software may remove radio station presets and settings from your GoTune.

Software updates for your GoTune may be available in the future. As software updates become available software and information on how to update your GoTune can be found at:

<http://www.sangean.com>

For more information, please contact our Head Office by sending an email to contact@sangean.com

1. Using the micro USB cable (supplied) to connect the USB socket on the rear of your GoTune and your PC.
2. With your GoTune switched on, press and hold the Info / Menu button to access the menu for the current mode.
3. Rotate the Tuning control knob to select “System” and press the Tuning control knob to enter the system settings menu.
4. Rotate the Tuning control knob to select “Software Upgrade” and press the Tuning control knob to enter the setting.
5. Rotate the Tuning control knob to select “Yes” or “No”. If you do not wish to carry out a software upgrade, select “No” and press the Tuning control knob to confirm the setting.
6. With “Yes” selected, press the Tuning control knob. The display will show “Waiting for PC wizard”.
7. Go to the website above to download the latest software. Follow the on-screen instructions on your PC provided with the upgrade software to complete the software upgrade.

NOTE

Do not switch off the power to the GoTune until the update operation is complete and the GoTune has restarted, otherwise the unit may become permanently damaged.

GB

F

E

NL

D

Software version

The software display cannot be altered and is just for your reference.

1. With your GoTune switched on, press and hold the Info / Menu button to access the menu for the current mode.
2. Rotate the Tuning control knob to select "System" and press the Tuning control knob to enter the system settings menu.
3. Rotate the Tuning control knob until "SW Version" appears on the display and press the Tuning control knob. The software version shows on the display.
4. Press the Back button to exit the software version display.

GB

F

E

NL

D

Specifications

Power Requirement	
Power supply	DC 5V cigarette type car power adaptor
Frequency Range	FM transmitter: 88.1 – 107.9 MHz
	DAB: 174.928 – 239.200 MHz
Bluetooth	
Bluetooth specification	Bluetooth® Ver 4.1
Profile Support	A2DP, AVRCP1.4, HFP1.6
Bluetooth Audio CODEC	SBC, AAC
Transmitting Power	Power Class 2
Line of sight range	10meters / 30feet
The frequency and maximum transmitted power	2402MHz – 2480MHz: 3.25dBm (Bluetooth EDR)
Circuit features	
Aux In socket	3.5mm diameter, stereo
Line Out socket	3.5mm diameter, stereo
Temperature range	Operational temperature: 0°C to +65°C
	Storage temperature: -40°C to +85°C

GB

F

E

NL

D

※ The barcode label on the product is defined as below:

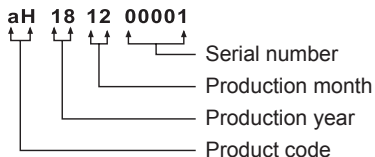

The company reserves the right to amend the specifications without notice.



If at any time in the future you should need to dispose of this product please note that: Waste electrical products should not be disposed of with household waste. Please recycle where facilities exist. Check with your Local Authority or retailer for recycling advice. (Waste Electrical and Electronic Equipment Directive)